



RiderPro

RiderPro is a motorcyclist restraint system designed to attach to the **ACP Sentry W Beam system** in order to reduce the impact severity for riders when colliding with roadside w-beam guardrail barrier.

RiderPro is positioned below the w-beam guardrail and prevents a sliding motorcyclist from contacting the supporting posts of the guardrail barrier.

RiderPro has been successfully crash tested in Class C60 with Severity Level I (highest level achievable) in accordance with the European Technical Specification CEN/TS 1317-8, attached to the ACP Sentry W Beam system. **RiderPro** has also undergone **MASH TL-3** compliance crash testing attached to the **ACP Sentry W Beam** system.

FEATURES

- Crash tested in Class C60 with Severity Level I (highest level achievable) in accordance with the European Technical Specification CEN/TS 1317-8
- MASH TL-3 Compliance crash tested attached to ACP Sentry W Beam system
- Easy to assemble and fast to install in all its applications
- Can be easily retrofitted to existing installations
- Lightest and most flexible motorcyclist restraint system on the market
- Can accommodate horizontal curves as low as 25m radius without pre-curving RiderPro rails
- Designed to be adaptable to future guardrail systems

SPECIFICATIONS

ACP Sentry Barrier W Beam System Panel section length	4.0 m
Mounting Bracket Spacing	2.0 m
System Mass	5.8 kg/m
RiderPro Panel Material	Galvanised Steel thickness 1.0 mm
Bracket Material	Galvanised Steel thickness 5.0 mm
System Coating	Hot-dip galvanised
RiderPro Panel Height Installed (vertical)	364 mm
RiderPro Ground Clearance	30 mm
RiderPro Horizontal Offset from Post	220 mm

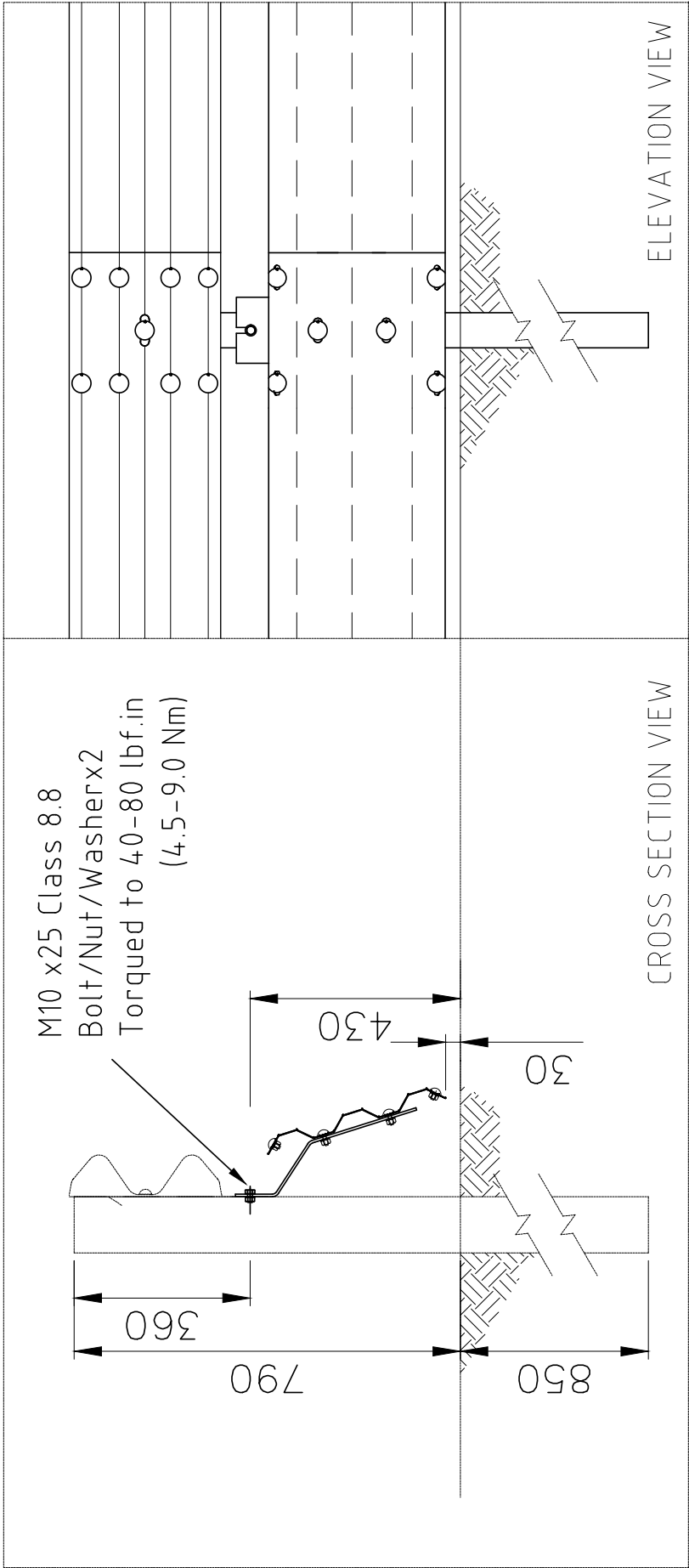

ELEVATION VIEW

CROSS SECTION VIEW

M10 x25 Class 8.8
Bolt/Nut/Washer x2
Torqued to 40-80 lbf.in
(4.5-9.0 Nm)

REV	DESCRIPTION	W.R.	24.07.20
		APPD	DATE
A	ORIGINAL ISSUE		
<p>ACP AUSTRALIAN CONSTRUCTION PRODUCTS Australian Construction Products Pty Ltd 339 Horsley Road Milperra NSW 2214 P.O. Box 565 Panania NSW 2213 Tel: +61 2 9772 4172 Fax: +61 2 9792 6272 <i>A member of the Fletcher Building Group</i></p>		<p>TOLERANCES Whole Numbers ±2 One Decimal Place ±0.05 Bend Angle : ±2 Straightness : 1.5per1500 Scale: N.T.S.</p>	
<p>CLIENT</p>		<p>ITEM ACP SENTRY BARRIER W BEAM SYSTEM WITH RIDERPRO MOTORCYCLIST DEVICE</p>	
<p>MATERIAL</p>		<p>DRAWING NUMBER S.B-RIDERPRO INSTALL</p>	
<p>FINISH</p>		<p>DRAWN W.R.</p>	<p>CHECKED APPROVED</p>